

DRIVE COUPLING IDENTIFICATION

A

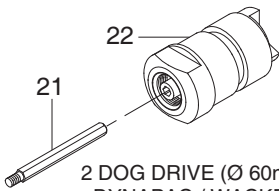

2 DOG DRIVE (Ø 60mm)
DYNAPAC / WACKER

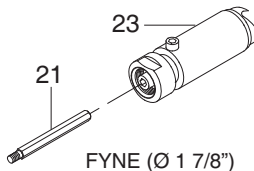

FYNE (Ø 1 7/8")

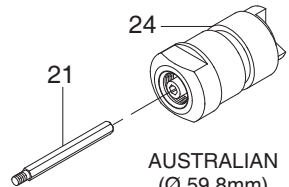

AUSTRALIAN
(Ø 59.8mm)

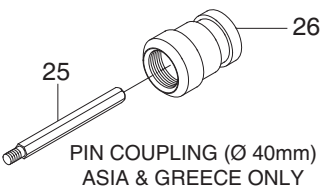

PIN COUPLING (Ø 40mm)
ASIA & GREECE ONLY

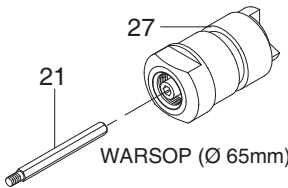

WARSOP (Ø 65mm)

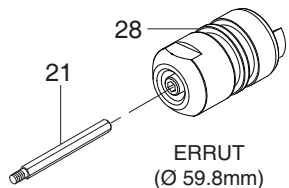

ERRUT
(Ø 59.8mm)

BGA 25 - 68

ITEM ⁽¹⁾ NUMBER	PART NUMBER ⁽⁴⁾								DESCRIPTION ⁽³⁾
	BGA 25	BGA 35	QTY ⁽⁴⁾	BGA 45	BGA 55	QTY ⁽⁴⁾	BGA 68	QTY ⁽⁴⁾	
1	165.0.122	165.0.012	1	165.0.027	165.0.043	1	165.0.143	1	NOSE CAP
2	165.0.123	165.0.013	2	165.0.028	165.0.044	1	165.0.144	2	'O' RING
3	165.0.124	165.0.010	1	165.0.025	165.0.041	1	165.0.141	1	HOUSING
4	165.0.125	165.0.176	1	165.0.026	165.0.042	1	165.0.142	1	PENDULUM
5	165.0.126	165.0.017	2	165.0.033	165.0.049	1	N/A	-	CIRCLIP
6	165.0.127	165.0.014	1	165.0.029	165.0.045	1	165.0.145	1	OIL SEAL
7	165.0.128	165.0.015	1	165.0.030	165.0.046	1	165.0.146	1	BEARING
8	165.0.129	165.0.016	1	165.0.031	165.0.047	1	N/A	-	SPRING WASHER
9	N/A	N/A	-	165.0.032	165.0.048	1	N/A	-	WASHER
10	165.0.130	165.3.007	1	165.3.008	165.3.009	1	165.0.150	1	OUTER CASING (COMPLETE)
11	165.0.131	165.0.019	1	165.0.035	165.0.140	1	165.0.034	1	END SHANK
12	165.0.132	165.0.018	1	165.0.034	165.0.034	1	165.0.034	1	END SHANK
13	165.0.133	165.0.022	1	165.0.038	165.0.038	1	165.0.038	1	CASING
14	165.0.134	165.0.051	1	165.0.051	165.0.051	1	165.0.051	1	SPIROL PROTECTOR
15	165.0.135	165.3.017	1	165.3.018	165.3.018	1	165.0.151	2	FLEXIBLE SHAFT (COMPLETE)
16	165.0.136	165.0.020	1	165.0.036	165.0.036	1	165.0.152	1	END SHANK
17	165.0.137	165.0.021	1	165.0.037	165.0.037	1	165.0.037	1	END SHANK
18	165.0.138	165.0.023	1	165.0.039	165.0.039	1	165.0.039	1	FLEXIBLE SHAFT
19	165.0.024	165.0.024	1	165.0.024	165.0.024	1	165.0.024	1	'O' RING
20	N/A	165.3.030	1	165.3.031	165.3.032	1	N/A	-	POKER HEAD ASSEMBLY

DRIVE COUPLINGS

ITEM ⁽¹⁾ NUMBER	PART ⁽²⁾ NUMBER	DESCRIPTION ⁽³⁾
21	165.0.053	DRIVER PIN (COMPATIBLE WITH ITEMS: 22, 23, 24, 27, 28)
22	165.3.000	COUPLING Ø 60mm - 2 DOG DRIVE (DYNAPAC/WACKER)
23	165.3.001	COUPLING Ø 1 7/8" (FYNE)
24	165.3.005	COUPLING Ø 59.8mm (AUSTRALIAN)
25	165.0.052	DRIVER PIN (COMPATIBLE WITH ITEM: 26)
26	165.3.003	COUPLING Ø 40mm - PIN TYPE (ASIA & GREECE ONLY)
27	165.3.004	COUPLING Ø 65mm (WARSOP)
28	44.2.117	COUPLING Ø 60mm (ERRUT)