

**MB 248**

**VIKING®**



<b>DE</b>	Gebrauchsanleitung	<b>HU</b>	Használati útmutató
<b>EN</b>	Instruction manual	<b>SR</b>	Uputstvo za upotrebu
<b>FR</b>	Manuel d'utilisation	<b>HR</b>	Priručnik
<b>NL</b>	Gebruiksaanwijzing	<b>CS</b>	Návod k použití
<b>IT</b>	Istruzioni per l'uso	<b>LV</b>	Lietošanas instrukcija
<b>ES</b>	Manual de instrucciones	<b>LT</b>	Naudojimo instrukcija
<b>PT</b>	Manual de utilização	<b>RO</b>	Instrucțiuni de utilizare
<b>NO</b>	Bruksanvisning	<b>EL</b>	Οδηγίες χρήσης
<b>SV</b>	Bruksanvisning	<b>RU</b>	Инструкция по эксплуатации
<b>FI</b>	Käyttöohjeet	<b>BG</b>	Упътване за употреба
<b>DA</b>	Betjeningsvejledning	<b>ET</b>	Kasutusjuhend
<b>PL</b>	Instrukcja obsługi	<b>MK</b>	Упътване за употреба
<b>SL</b>	Navodila za uporabo		
<b>SK</b>	Návod na obsluhu		
<b>TR</b>	Kullanım Kılavuzu		

MB 248.0

**C**

**INT 1**

[www.viking-garden.com](http://www.viking-garden.com)





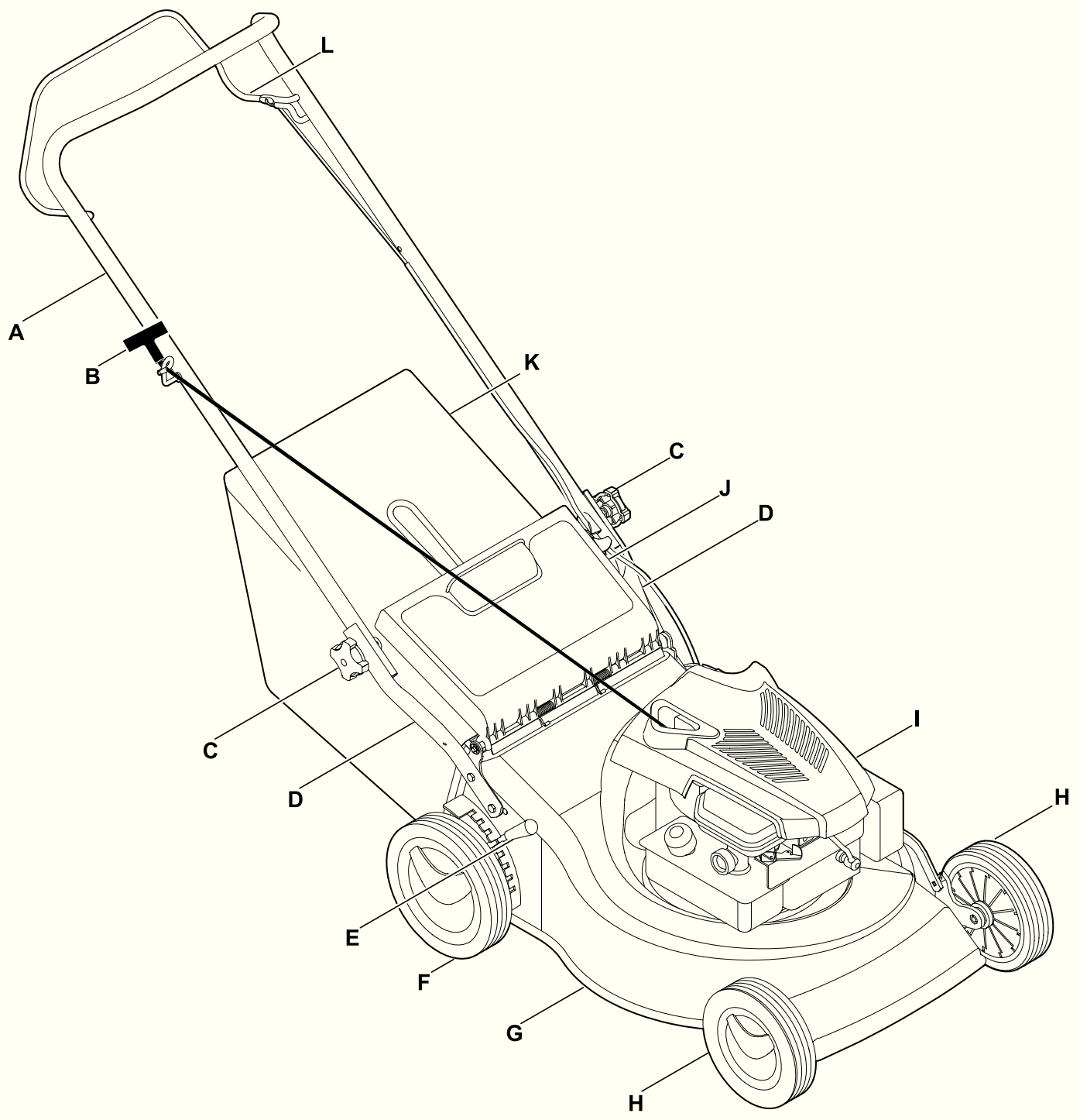



2

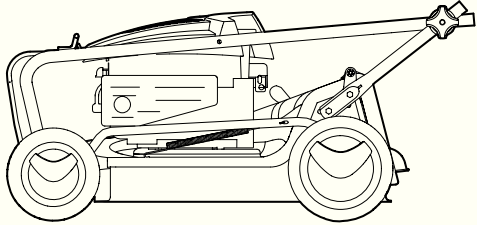

1

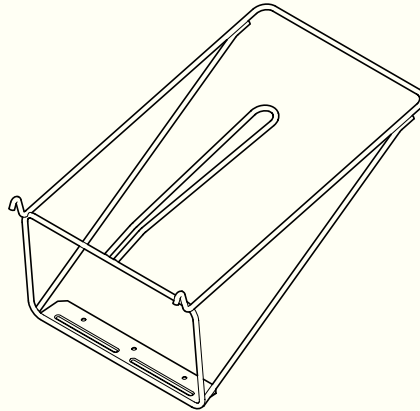

2

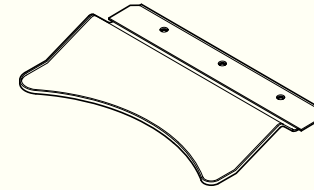

3

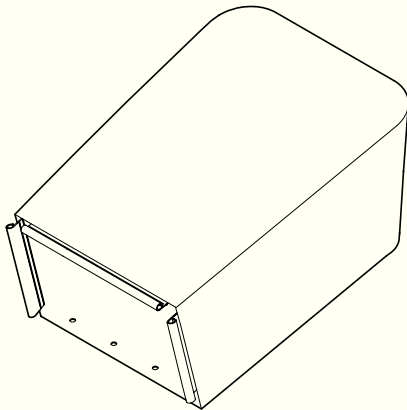

4

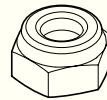

5

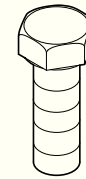

6



3

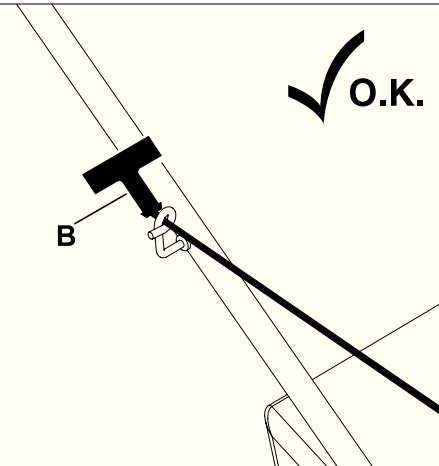
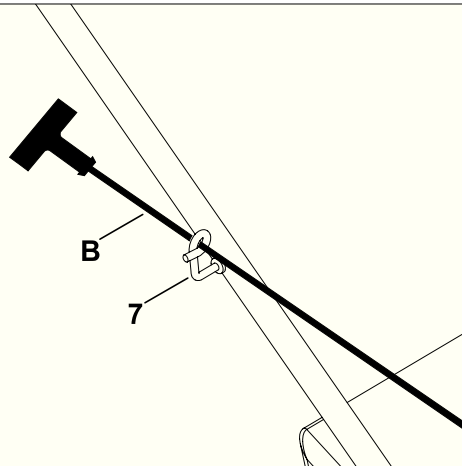
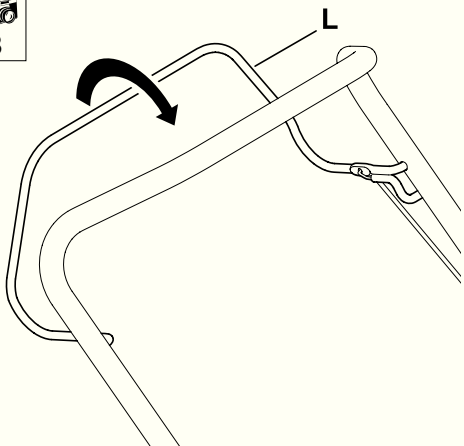

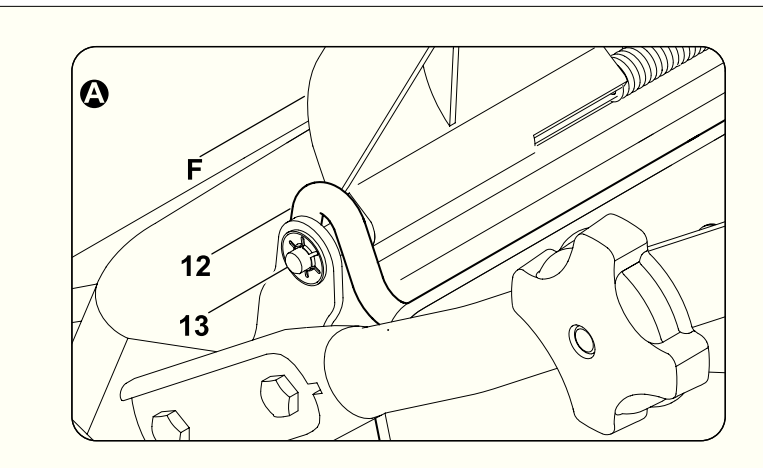
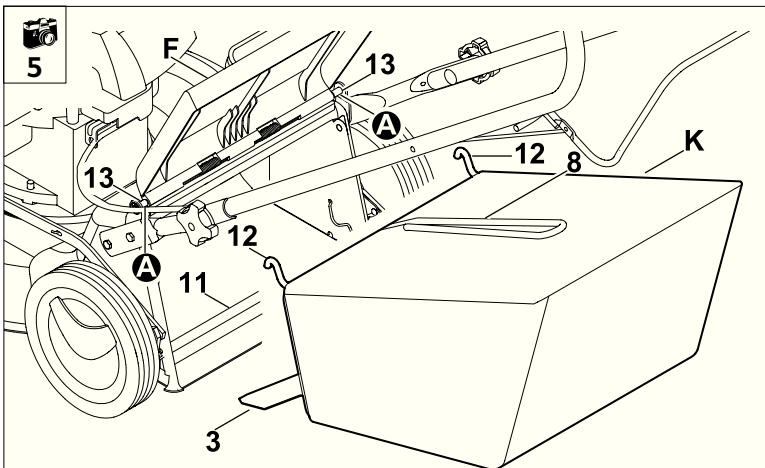
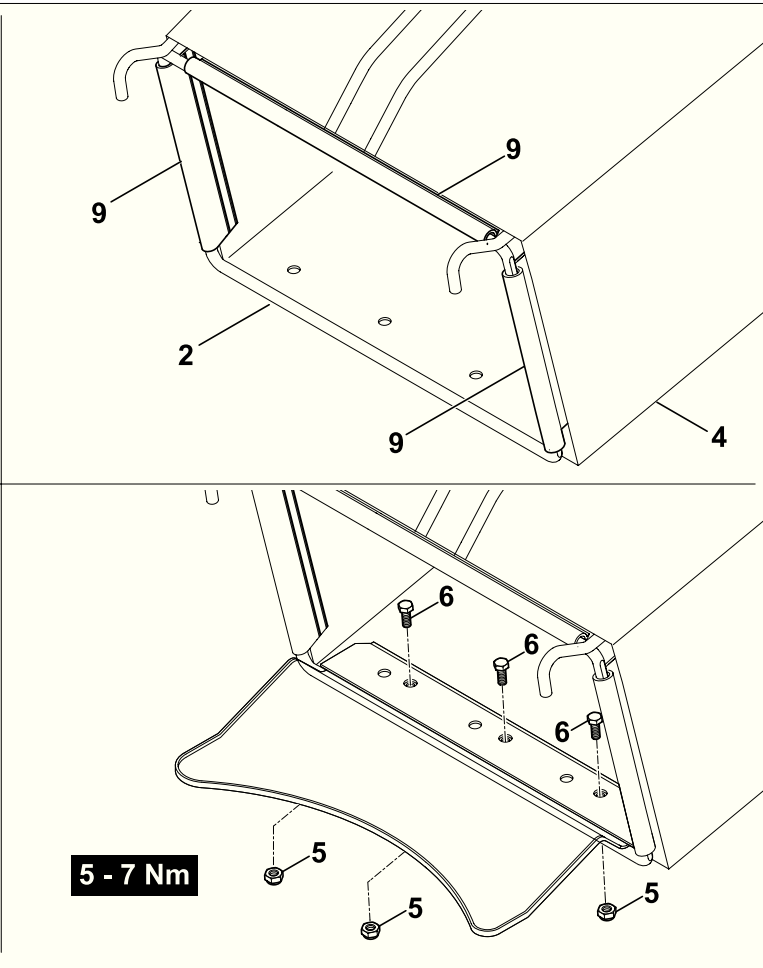
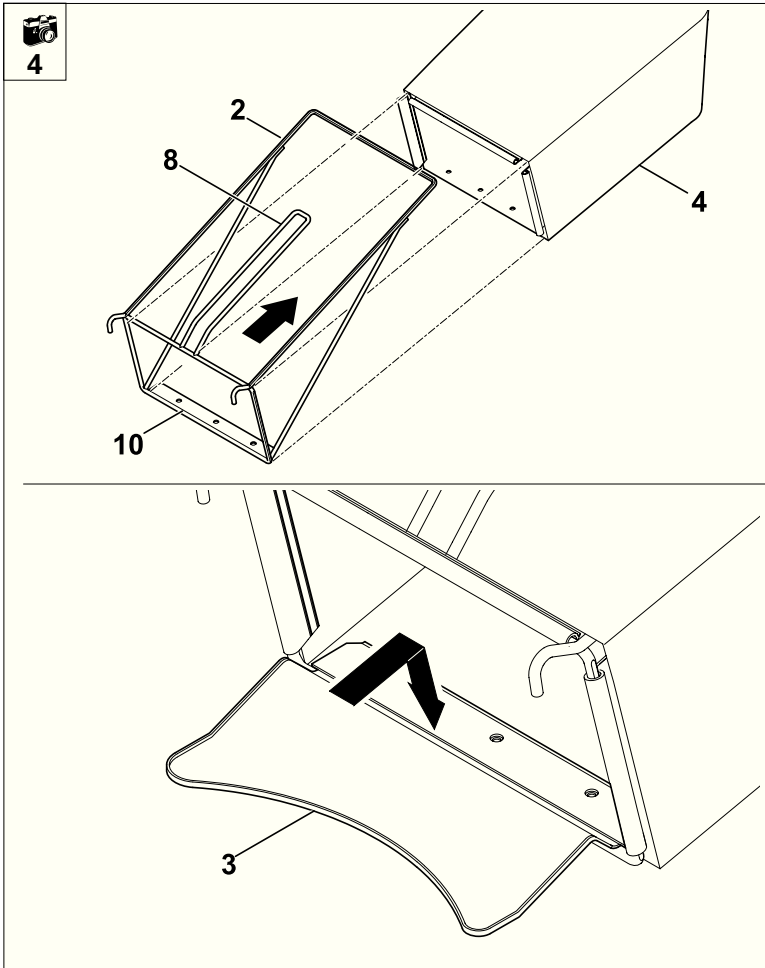

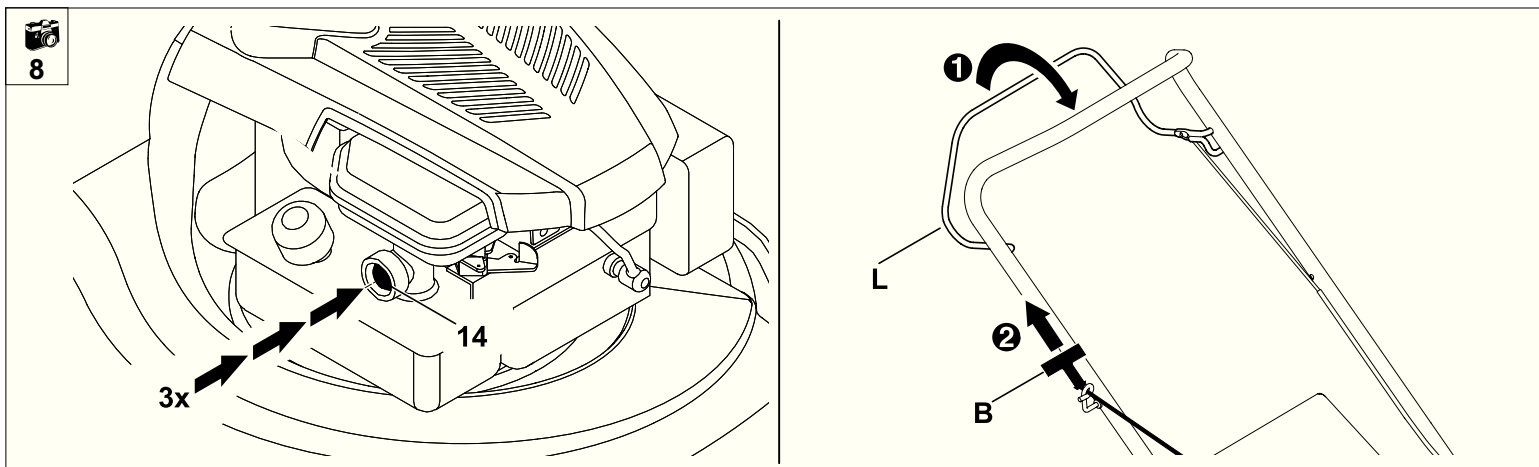
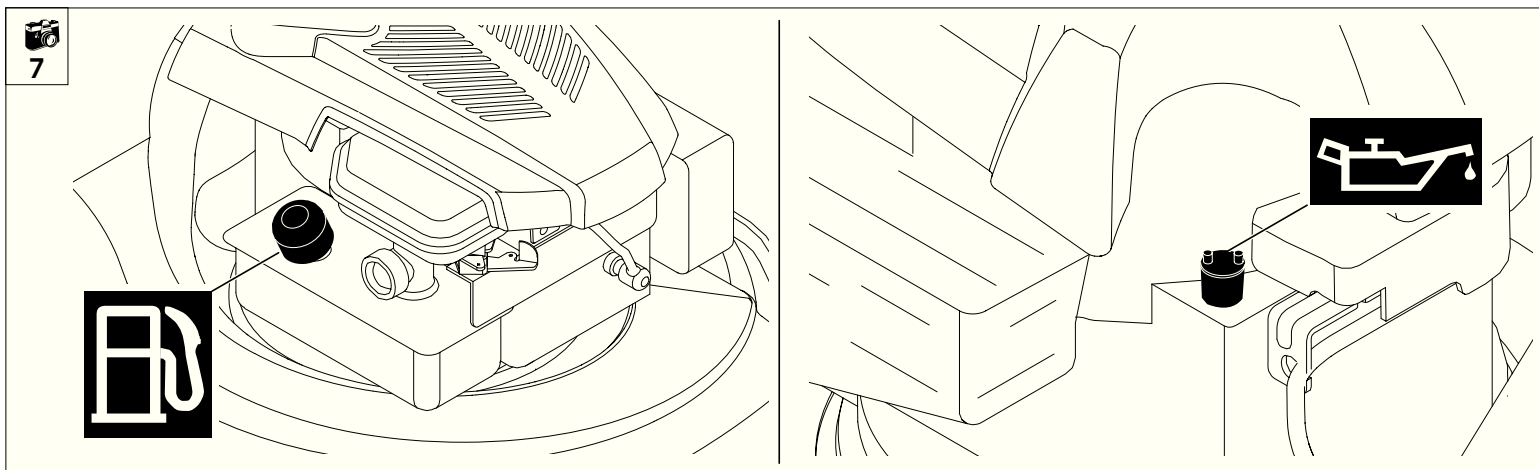
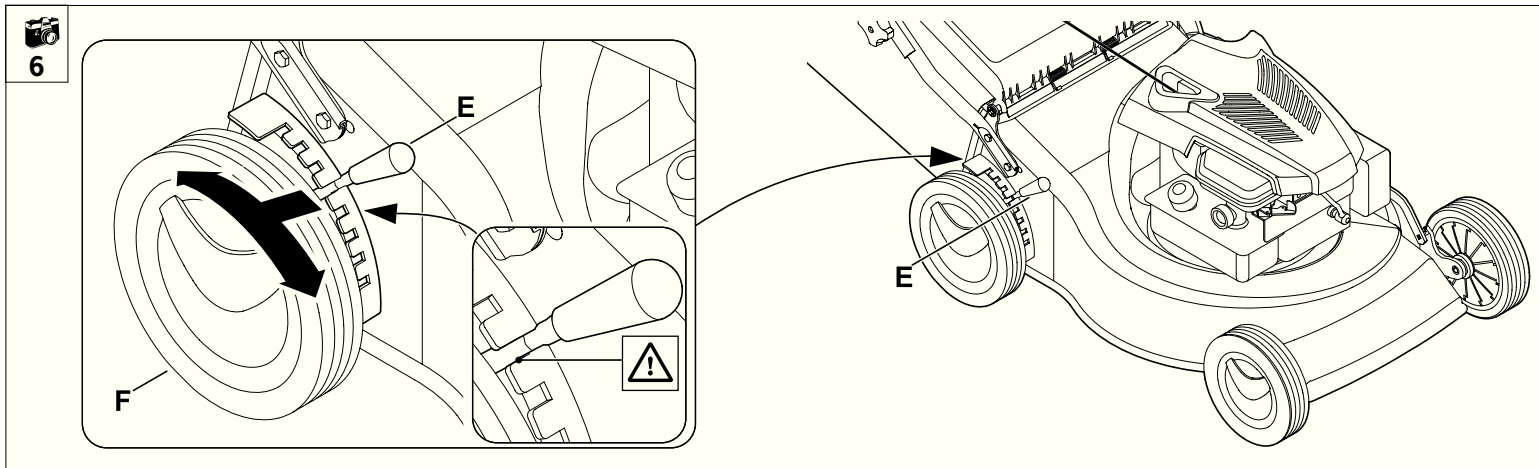

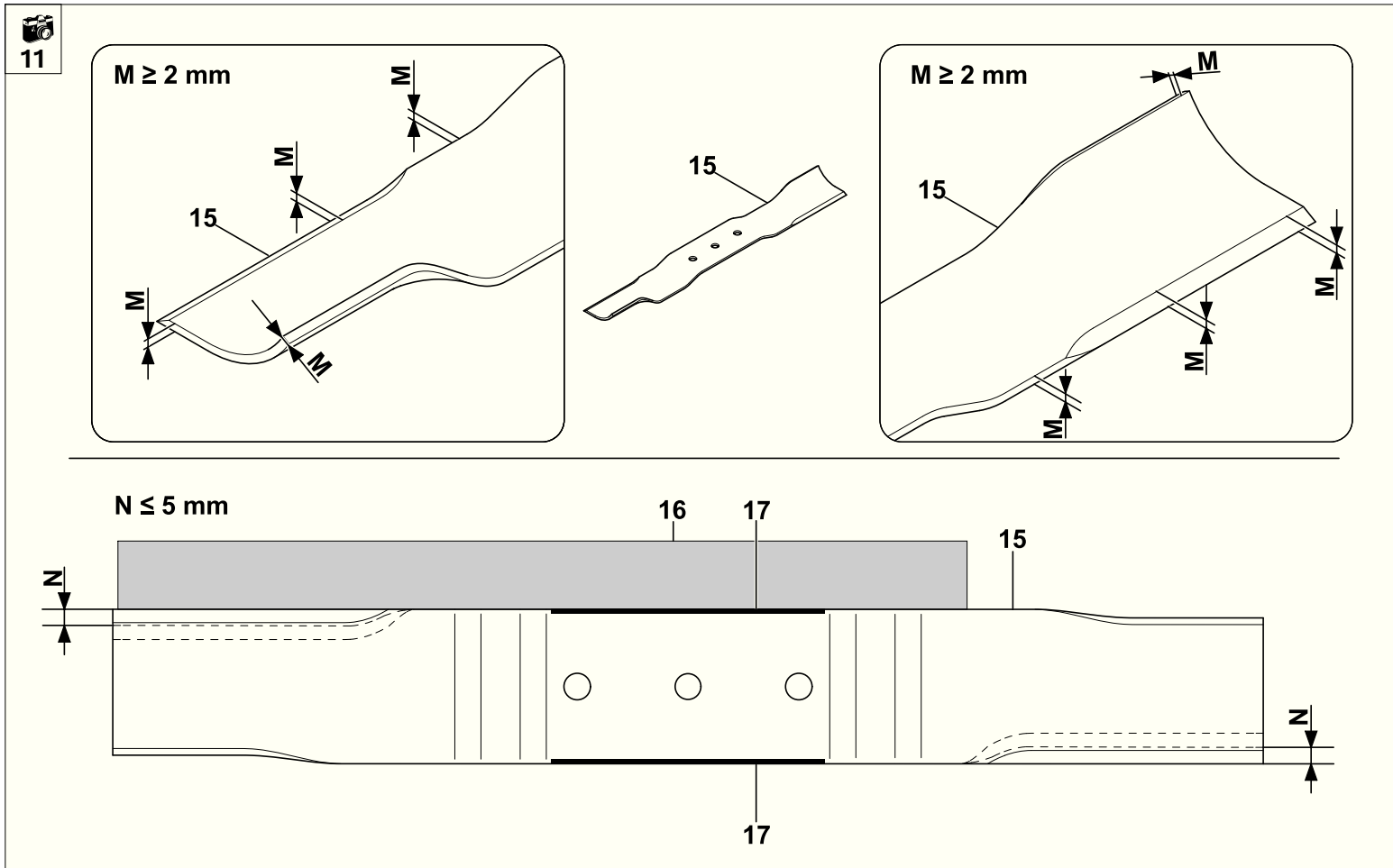
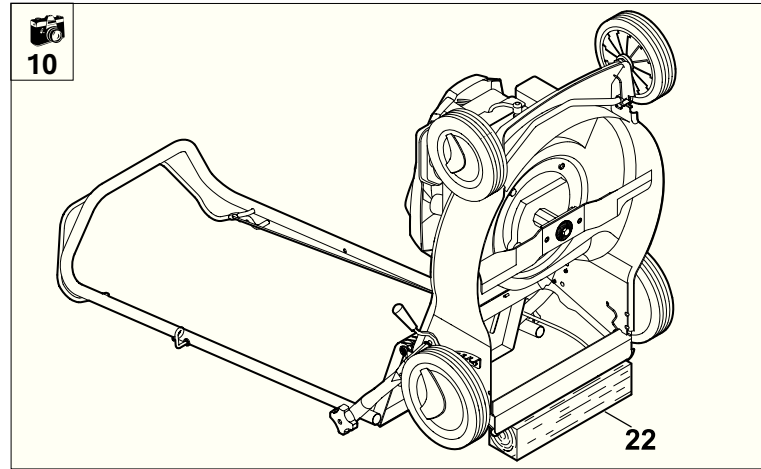
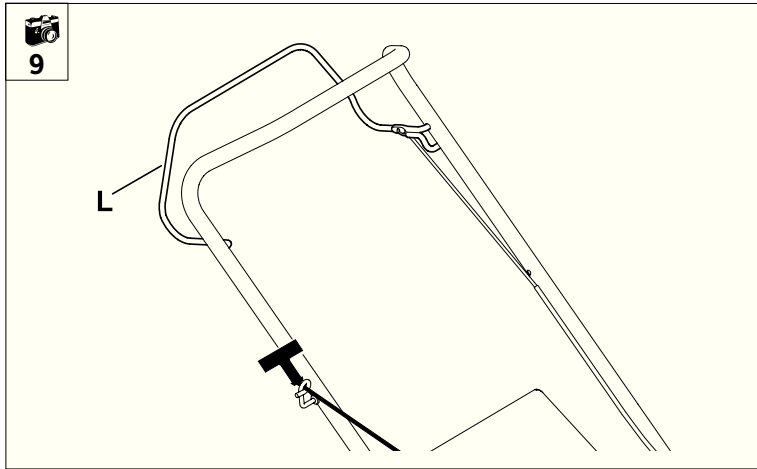

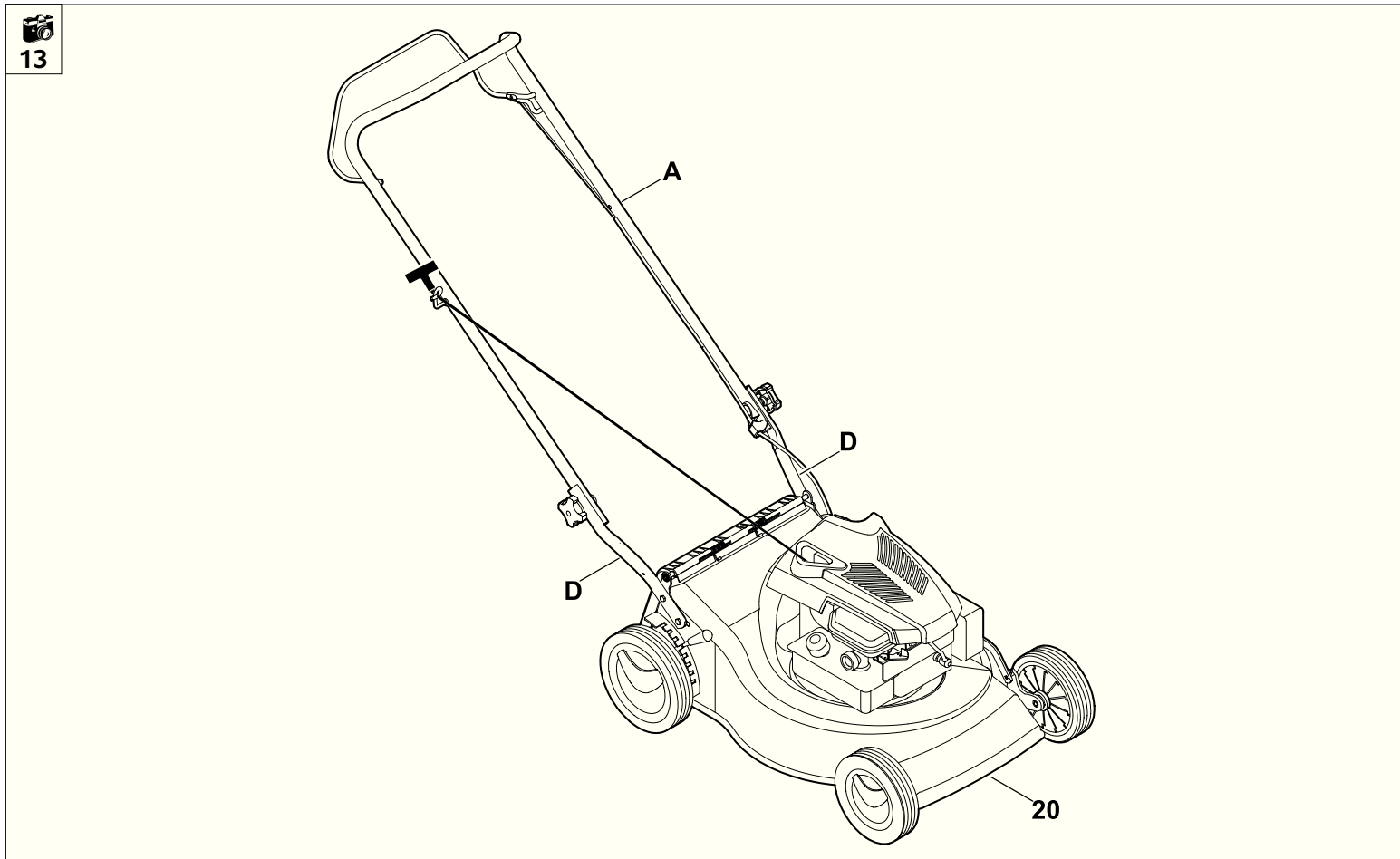
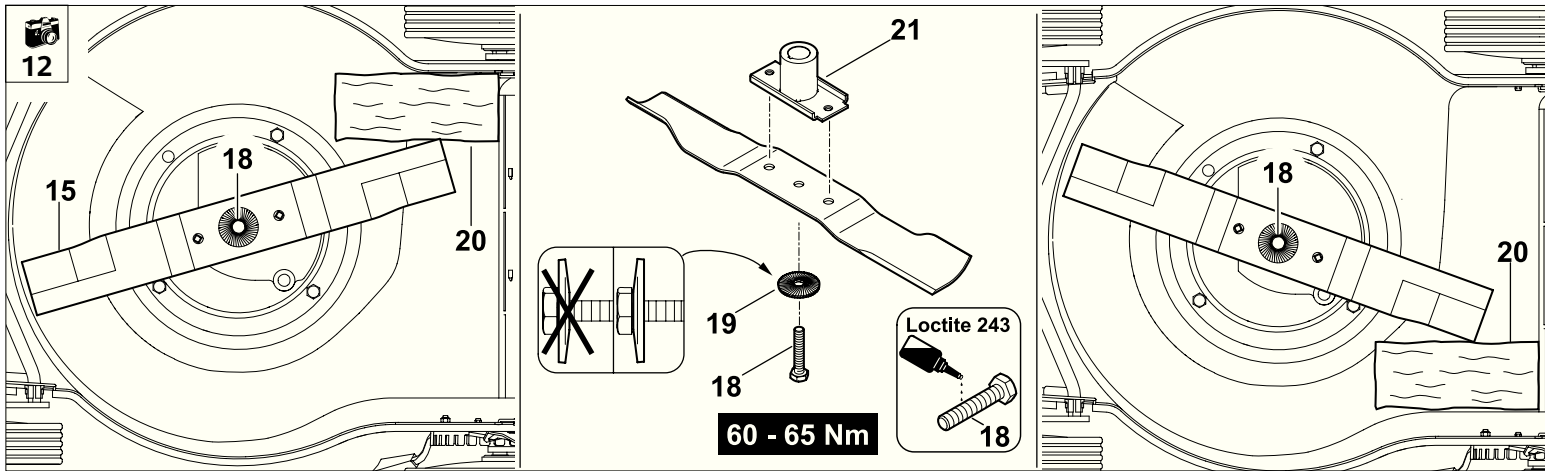



Dear Customer,

Thank you for choosing a VIKING quality product.

This product has been produced using state-of-the-art production methods and extensive quality assurance procedures, because our goal is only achieved if you, the customer, are satisfied with your machine.

If you have any questions concerning your machine, please contact your dealer or our sales agency directly.

**I hope that your VIKING machine will give you great enjoyment.**

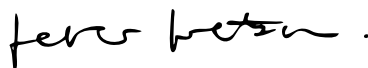

**Dr. Peter Pretzsch**

**Manager**

VIKING is continually striving to further develop its range of products; we therefore reserve the right to make alterations to the form, technical specifications and equipment level of our standard equipment.

The information and illustrations in this manual are therefore subject to alterations.

## 01. Table of contents

<b>01. Table of contents</b>	<b>1</b>	<b>11. Maintenance</b>	<b>11</b>
<b>02. Notes on the instruction manual</b>	<b>2</b>	11.01 Cleaning the machine	11
<b>03. Machine overview</b>	<b>2</b>	11.02 Combustion engine	11
<b>04. For your safety</b>	<b>2</b>	11.03 Wheels	11
04.01 General	2	11.04 Wear limit for mowing blades	11
04.02 Transport	3	11.05 Mowing blade maintenance	11
04.03 Preparatory measures	3	11.06 Storage and winter break	12
04.04 Mowing procedure	4	<b>12. Transport</b>	<b>12</b>
04.05 Maintenance and storage	5	<b>13. Minimising wear and preventing damage</b>	<b>13</b>
04.06 Warning: petrol is poisonous and extremely inflammable	6	<b>14. Environmental protection</b>	<b>13</b>
04.07 Disposal	7	<b>15. Standard spare parts</b>	<b>13</b>
<b>05. Description of symbols</b>	<b>7</b>	<b>16. Technical specifications</b>	<b>14</b>
<b>06. Standard equipment</b>	<b>7</b>	<b>17. CE - Manufacturer's declaration of conformity</b>	<b>14</b>
<b>07. Preparing the machine for operation</b>	<b>8</b>	<b>18. Troubleshooting</b>	<b>15</b>
07.01 Assembling the handlebar	8	<b>19. Service schedule</b>	<b>16</b>
07.02 Folding down the upper handlebar	8		
07.03 Attaching and detaching the recoil starter rope	8		
07.04 Assembling the grass catcher bag	8		
07.05 Attaching and detaching the grass catcher bag	9		
07.06 Central cutting height adjustment	9		
07.07 Fuel and engine oil	9		
<b>08. Safety device</b>	<b>10</b>		
08.01 Motorstop lever	10		
<b>09. Notes on mowing</b>	<b>10</b>		
<b>10. Initial operation of the machine</b>	<b>10</b>		
10.01 Starting the engine	10		
10.02 Stopping the engine	10		
10.03 Emptying the grass catcher bag	10		

**Note:**

This instruction manual constitutes **original manufacturer's instructions** in the sense of EC Directive 2006/42/EC.

## 02. Notes on the instruction manual

### Illustration symbols



This symbol serves to link the Figs. on the illustration pages with the corresponding text passages in the instruction manual.

The figures can be found at the front of the instruction manual.

### Designation of text passages

The operating steps described may be designated in different ways.

Operating step **with** direct reference to the relevant figure to be found in the illustration pages (at the front of the instruction manual), with a corresponding reference to the item number in the figure.

Example:

- Release bolt (1), operate lever (2).

General lists, which do not refer to the illustrations.

Example:

- use of the product for sporting or competitive events

In addition to descriptions of operating steps, this instruction manual includes text passages containing important additional information. Such passages are identified using the symbols described below in order to especially emphasise them in the instruction manual:



Danger of accident and risk of injury to persons and serious damage to property.



Information for better use of the machine and in order to avoid possible operating errors, which may result in damage to the machine or to the individual components.

Viewing direction when “**left**” and “**right**” is used in the instruction manual: the user is standing behind the machine (working position) and is looking forwards in the direction of travel.

## 03. Machine overview



- A Upper handlebar
- B Recoil starter rope
- C Rotary handle
- D Lower handlebar
- E Cutting height adjustment lever
- F Rear wheel
- G Housing
- H Front wheel
- I Engine
- J Discharge flap
- K Grass catcher bag (fabric)
- L Motorstop lever

## 04. For your safety

### 04.01 General



These safety regulations must be observed when working with the lawn mower.



Read the whole instruction manual before using the machine for the first time and keep in a safe place for future reference.

- Observe the operating and maintenance instructions contained in the separate engine instruction manual.
- Ensure that you are familiar with the controls and use of the machine.
- Before initial use, advice should be obtained from the specialised dealer or other technician.
- The lawn mower should not be operated after the consumption of alcohol, medications which impair reactions, or drugs.
- **Caution!**  
The lawn mower is only intended for mowing lawns; its use for other purposes is not permitted and may be dangerous or result in damage to the machine.  
Risk of injury!

- Particular care is required during use in public green spaces, parks, sports fields, along roads and in agricultural and forestry businesses.
  - Objects hidden in the grass (lawn sprinkler systems, posts, water valves, foundations, electrical wires, etc.) must be avoided. Never intentionally run over any such foreign objects.
  - This machine is not suitable for use by persons (including children) with impaired physical, sensory or mental faculties or those lacking the appropriate experience and/or knowledge, unless supervised by a person responsible for their safety or having received instructions on use of the machine from such person.
- Children must be supervised, in order to ensure that they do not play with the machine.

- Due to the physical danger to the user, the lawn mower must not be used, for example, for the following applications (incomplete list):
  - trimming bushes, hedges and shrubs,
  - cutting creepers, care of lawn roofs and balcony boxes,
  - shredding and chopping tree and hedge cuttings,
  - levelling earth mounds, e.g. mole hills.



**Caution! Danger to health due to vibrations.**

- Excessive exposure to vibrations can result in damage to the cardiovascular or nervous system, particularly in persons with cardiovascular problems. Please consult your physician if you experience symptoms that may have been caused by vibrational loads.

Such symptoms include loss of feeling, pain, muscular weakness, skin discolouration or an unpleasant tingling sensation. These symptoms principally affect the fingers, hands or wrists.

- This machine is not suitable for use by persons (including children) with impaired physical, sensory or mental faculties or those lacking the appropriate experience and/or knowledge, unless supervised by a person responsible for their safety or having received instructions on use of the machine from such person.

**04.02 Transport**

- Always wear gloves in order  to prevent injuries due to sharp-edged and hot components.
- Switch off the machine prior to transport, detach the spark plug socket and allow the blade to come to a standstill.

- Only transport the machine once the engine has cooled down and with an empty fuel tank.
- Pay particular attention to the information in the “Transport” section.

**04.03 Preparatory measures**

- Never allow children under the age of 16 to use the lawn mower. Local regulations may specify a minimum age for users.
- Persons who are not familiar with the instruction manual are not authorised to use the machine.
- Never use the machine in the vicinity of other persons, particularly children, or animals.
  - Be aware that the person operating the machine or the user is responsible for accidents involving third parties or their property.
- Always wear robust shoes  and long trousers when working. Never work bare-foot or in sandals.

- Carefully inspect the complete area on which the machine is to be used and remove any stones, sticks, wires, bones and other foreign objects which could be thrown up by the machine.
- Before using the machine, always visually inspect the cutting tool, the fastening bolts and the entire cutting unit for wear or damage (notches or cracks). Replace worn or damaged parts.
- The wear limit of the mowing blade must be checked before each use. (⇒ 11.04)
- Never use the lawn mower if the safety devices (e.g. motorstop lever, discharge flap, housing, protective grille) are missing, damaged or worn.
- For safety reasons, the grass catcher bag must only be used if undamaged.

- The switch mechanisms installed in the machine must not be removed or bypassed, e.g. by tying the motorstop lever to the handlebar.
- Only give (or lend) the machine to persons who are familiar with this model and how to operate it. Always provide them with the instruction manual.
- Please observe the local regulations regarding permitted operation times for gardening power tools.

#### 04.04 Mowing procedure

- Keep other persons away from the danger area.



- Do not run the combustion engine in an enclosed space, where dangerous carbon monoxide can accumulate.
- **Danger to life through poisoning!**
- Only work during the day or with good artificial light.

- If possible, avoid using the machine when the ground is wet, otherwise, exercise particular caution to prevent yourself from slipping. The risk of accidents is higher if the ground is wet (increased danger of slipping for operator).
- Always ensure good stability on slopes. Avoid mowing on excessively steep slopes in order to prevent loss of control of the machine.
- Never attach any objects to the handlebar (e.g. work clothing).
- Only mow at walking speed. Working quickly with the machine increases the risk of injury due to stumbling, slipping etc.
- Only mow at right-angles to the slope and never up or down the slope, in order to avoid being run over by the running lawn mower in the case of loss of control of the machine or of falling.
- Be particularly careful when changing direction on a slope.

- For safety reasons, the machine must not be used on slopes with an incline of more than 25° (46.6 %). Risk of injury!  
A slope inclination of 25° corresponds to a vertical height increase of 46.6 cm for a 100 cm horizontal distance.

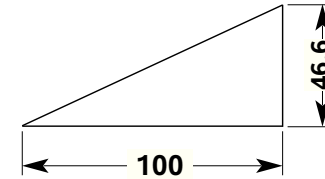

In order to ensure an adequate oil supply for the engine, the information in the accompanying engine instruction manual must be additionally observed when using the machine on slopes.

- Be particularly careful when turning the lawn mower around or pulling it towards you.
- **Risk of stumbling!**
- Do not alter the basic setting of the engine or run at excessive engine speeds.
- Exercise particular care when starting the lawn mower and observe the instructions contained in the “Initial operation of the machine” section.

- Ensure that you keep your feet far enough away from the work tools. The safety distance provided by the correctly installed handlebar must be maintained.
- The machine must not be tilted when starting the engine. Observe the instructions contained in the “Initial operation of the machine” section.
- Do not start the engine if the discharge chute is not covered by the discharge flap or the catcher bag.
- **Warning - risk of injury:**  
 Never put hands or feet on or underneath rotating parts. Always keep away from the discharge opening. Always observe the safety distance provided by the handlebar.
- Beware of the work tools running on for several seconds before coming to a standstill.  
 **STOP**
- Switch off the engine and detach the spark plug socket before lifting or carrying the lawn mower.

- Switch off the engine:
  - When the machine has to be tilted for transportation.
  - When the machine is being pushed to and from the area to be mown.
  - Before pushing the lawn mower onto a surface not covered with grass.
  - When you open or remove the grass catcher bag.
- Switch off the engine and detach the spark plug socket:
  - Before remedying blockages, including those in the discharge chute.
  - Before checking, cleaning or working on the lawn mower.
  - After hitting a foreign object. Inspect the machine, in particular the cutting unit, for damage and have any necessary repairs carried out by a technician before starting and working with the machine again. VIKING recommends VIKING specialist dealers.

- If the lawn mower begins to vibrate excessively, inspect the machine, in particular the cutting unit (blade, blade shaft, blade fastening), for damage and have any necessary repairs carried out by a technician. Strong vibrations are generally an indication of a fault. VIKING recommends VIKING specialist dealers.
- Switch off the engine:
  - Whenever you leave the lawn mower unattended.
  - Before re-filling the tank.

**Fire hazard!**

#### 04.05 Maintenance and storage

If you do not have the necessary expertise or auxiliary equipment, please **always** contact a specialist dealer. (VIKING recommends VIKING specialist dealers).



Always detach the spark plug socket before performing any work on the machine.



#### **Warning** **Danger of burns!**

The engine can become extremely hot. In order to prevent burns, allow the engine exhaust and exhaust guard to cool down before performing maintenance operations and before storing the machine.



#### **Risk of injury!** Always wear gloves.

- Only carry out maintenance operations that are described in this instruction manual. All other work should be carried out by a specialist dealer.
- VIKING recommends that you have maintenance operations and repairs performed exclusively by a VIKING specialist dealer.
- VIKING specialist dealers regularly attend training courses and are provided with technical information.
- Only use high-quality tools, accessories and spare parts, otherwise there may be a risk of accidents resulting in personal injury or damage to the machine.

DE

EN

FR

NL

IT

ES

PT

NO

SV

FI

DA

PL

SL

SK

TR

- VIKING recommends the use of genuine VIKING tools, accessories and spare parts. Their properties are optimally adapted to the machine and the user's requirements..

Genuine VIKING spare parts can be recognised from the VIKING spare parts number, by the VIKING logo and, if present, by the VIKING spare parts symbol.

On smaller parts, only the symbol may be present.

- Carefully clean the lawn mower following use. Remove accumulated clipping deposits using a stick. Clean the underside of the mower with a brush and water.
- Never use high-pressure cleaners and do not clean the lawn mower under running water (e.g. using a garden hose). Do not use aggressive cleaning agents. These cleaners can damage plastics and metals, impairing safe operation of your VIKING machine. Observe the instructions in the "Maintenance" section.
- Ensure that all nuts, pins, bolts and screws are securely tightened, so that the machine is in a safe operating condition at all times.
- Replace danger signs and warnings on the machine which have become illegible. Your VIKING dealer has a stock of replacement stickers.
- Check the complete machine and the grass catcher bag regularly
  - particularly before storing the machine for prolonged periods (over winter)
  - for wear or damage. Replace worn or damaged parts to ensure that the machine is always in a safe operating condition.
- In order to prevent fire hazards, keep the engine, exhaust, and the area around the fuel tank free from grass, straw, moss, leaves or emerging grease.

- Store the cooled lawn mower safely in a dry, well-ventilated and locked place that is inaccessible to children.

**04.06 Warning: petrol is poisonous and extremely inflammable**



- Petrol must only be stored in appropriate containers.
- Keep petrol away from sparks, naked flames, pilot lights, heat sources, and other ignition sources. 
- Re-fill the tank out of doors and do not smoke during re-filling.
- Do not fill fuel tank completely, but fill to approx. 4 cm below the edge of the filler neck so that the fuel has room to expand.

- Re-filling with petrol must be performed before the engine is started. When the engine is running or is hot, the tank cap must not be removed and the tank must not be re-filled with petrol. Petrol may be spilled.

**Fire hazard!**

- If the petrol tank overflows, no attempt must be made to start the engine. The machine must be removed from the area contaminated with petrol. All attempts at starting must be avoided until the petrol fumes have dispersed (wipe dry).
- Screw on caps of fuel tank and canister properly and tightly.
- For safety reasons, the fuel line, fuel tank, tank cap and connections must be checked regularly for damage, ageing (brittleness), firm seating and leaks. Replace if necessary (consult a specialist dealer; VIKING recommends a VIKING specialist dealer).

- Replace damaged mufflers and guard plates. The lawn mower may not be used with a defective muffler.
- Never store the machine with petrol in the tank inside a building in which the petrol fumes could come into contact with naked flames or sparks and could be ignited.
- Allow the engine to cool before storing the machine in an enclosed space.
- The machine generates poisonous exhaust gases when the engine is running.



These gases may be odourless and invisible. Never work with engine-powered machines in closed or poorly ventilated spaces.

**Danger to life through poisoning!**

- If it is necessary to drain the tank, this must be done out of doors (e.g. by driving until empty). Drained fuel should be stored in a special container intended for that purpose, or disposed of with special care.

#### 04.07 Disposal

Read the information in the “Environmental protection” section.

Ensure that an old lawn mower, engine oil and petrol are disposed of properly. Render the machine unusable prior to disposal. Remove the ignition lead, empty the fuel tank and drain the engine oil in particular. Observe regional regulations.

## 05. Description of symbols



### Warning:

Read the instruction manual before initial use.



### Risk of injury!

Keep other persons away from the danger area.

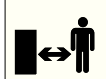

### Risk of injury!

Detach the spark plug socket before performing work on the cutting tool or maintenance and cleaning work.

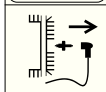

### Risk of injury!

Cutting tool runs on for several seconds after switching off (engine / blade brake)



## 06. Standard equipment

Item	Designation	Qty.
		 2
1	Basic unit	1
2	Grass catcher bag frame	1
3	Guiding plate (grass catcher bag)	1
4	Grass catcher bag fabric	1
5	Lock nut	3
6	Screw	3
	• Instruction manual	1
	• Instruction manual Engine	1

DE

EN

FR

NL

IT

ES

PT

NO

SV

FI

DA

PL

SL

SK

TR



## 07. Preparing the machine for operation

### 07.01 Assembling the handlebar



#### WARNING



#### Danger of pinching!

When folding it up, hold the upper handlebar (A) with one hand at its highest point while you screw in both rotary knobs (C).

- Press and hold the motor-stop lever (L) against the upper handlebar (A).
- Fold the upper handlebar (A) upwards as shown and hold in position.
- Screw in and tighten the rotary knob (C) on each side by turning clockwise.
- Release the motorstop lever (L) and upper handlebar (A).

#### NOTE



#### Avoid damage to the machine.

In order to prevent damage to the engine hood when folding up the upper handlebar (A), the motorstop lever (L) must be pressed and held.

### 07.02 Folding down the upper handlebar



Fold down the upper handlebar (A) for space-saving transport and storage of the mower.

#### WARNING



#### Risk of injury!

The engine must be switched off and the spark plug socket detached prior to folding down the handlebar. No loads must be placed on the upper handlebar (e.g. hanging work clothing over the handlebar).

#### Danger of pinching!

The upper handlebar (A) can be folded down by releasing the rotary knobs (C). For this reason, always hold the upper handlebar (A) with one hand at its highest point when you unscrew the rotary knobs (C).

- Detach the recoil starter rope (B). (⇒ 07.03)
- Press and hold the motor-stop lever (L) against the upper handlebar (A).
- Loosen the handles (C) on each side (by turning anti-clockwise).
- Fold down the upper handlebar (A) forwards.
- Release the motorstop lever (L).

### 07.03 Attaching and detaching the recoil starter rope



#### Attaching:

Detach the spark plug socket from the engine.

- Press and hold the motor-stop lever (L).
- Slowly pull out the recoil starter rope (B) and attach it at the rope holder (7).
- Slowly release the recoil starter rope (B) and motor-stop lever (L).

Connect the spark plug socket.

#### Detaching:

Detach the spark plug socket from the engine.

- Press and hold the motor-stop lever (L).
- Slowly pull out the recoil starter rope (B) and detach it from the rope holder (7).
- Slowly return the recoil starter rope (B) and release the motorstop lever (L).

### 07.04 Assembling the grass catcher bag



#### NOTE



Do not pull the grass catcher bag fabric (4) over the handle (8) of the grass catcher bag frame (2) during assembly.

- Pull the grass catcher bag fabric (4) over the catcher bag frame (2) as shown. Ensure that the handle (8) on the top of the grass catcher bag is not covered by the fabric (4).
- Fasten the clips (9) of the grass catcher bag fabric (4) at the top and sides of the grass catcher bag frame (2).

#### NOTE



When installing the guiding plate (3), the grass catcher bag fabric (4) must be positioned between the retaining plate (10) on the grass catcher bag frame and the guiding plate (3).



- Position the grass catcher bag fabric (4) on the retaining plate (10) of the grass catcher bag frame, bringing the bores into alignment.
- Place the guiding plate (3) onto the grass catcher bag fabric (4) and the retaining plate (10) from above as shown.
- Insert three screws (6) through the bores from above.
- Screw in nuts (5) and tighten to **5 - 7 Nm**.

#### 07.05 Attaching and detaching the grass catcher bag



#### WARNING



#### Risk of injury!

The engine must be switched off before attaching or detaching the grass catcher bag.

#### Attaching:

- Open the discharge flap (F) and hold.

Hold the grass catcher bag (K) by the handle (8) and guide it to the discharge chute on the lawn mower. Position the guiding plate (3) on the grass catcher bag over the crossbar (11) in the discharge chute of the lawn mower.

- Attach both snap-in hooks (12) of the grass catcher bag to the grass catcher bag mount (13) from above.
- Slowly close the discharge flap (F) again.

#### Detaching:

- Open and hold the discharge flap (F).
- Hold the grass catcher bag (K) by the handle (8) and lift it until both snap-in hooks (12) are detached from the grass catcher bag mount (13).

Remove the grass catcher bag (K) rearwards while carefully pulling the guiding plate (3) on the grass catcher bag out of the discharge chute.

- Slowly close the discharge flap (F) again.

#### 07.06 Central cutting height adjustment



#### WARNING



#### Risk of injury!

The engine must be switched off before adjusting the cutting height.

There are **8** different cutting height settings available, from **23 mm** to **73 mm**.

The lowest cutting height level is selected when the cutting height adjustment lever (E) is in the uppermost position.

The highest cutting height level is selected when the cutting height adjustment lever (E) is in the lowermost position.

- Press the cutting height adjustment lever (E) to the rear wheel (F) and hold in position.
- Set the cutting height adjustment lever (E) to the required position.
- Slowly release the cutting height position lever again and allow it to engage.

#### 07.07 Fuel and engine oil



#### NOTE



Top up engine oil before initial start (⇒ engine instruction manual).

#### Engine oil



Please consult the engine instruction manual for the type of engine oil to be used and the oil capacity.

Check the engine oil level at regular intervals (⇒ engine instruction manual).

Avoid exceeding or falling below the correct oil level.

#### Fuel



Recommendation:

Fresh good quality fuel, normal unleaded petrol (⇒ engine instruction manual).

It is recommendable to use a funnel when filling the tank with fuel (not included in standard equipment).

Note the warnings in the “For your safety” section.

DE

EN

FR

NL

IT

ES

PT

NO

SV

FI

DA

PL

SL

SK

TR

## 08. Safety device

### 08.01 Motorstop lever



1

The lawn mower is equipped with a motorstop device.

The engine with the mowing blade stops immediately when the motorstop device is triggered (release of the motorstop lever (L)) and comes to a complete standstill within a few seconds.

## 09. Notes on mowing

To ensure a perfect, thick lawn, mow regularly and keep the grass short. Do not cut it too short in hot, dry conditions as the lawn will dry out or burn in the sun and become unsightly.

The cutting pattern will be better with a sharp blade than with a blunt one. The blade must therefore be sharpened regularly (dealer).

## 10. Initial operation of the machine

### WARNING

#### Risk of injury!

Carefully read and observe the “For your safety” section and the safety instructions before operating the lawn mower.

### 10.01 Starting the engine



8

### NOTE



Do not start the engine in high grass or when the mower is set to the lowest cutting height, as this makes starting difficult.

Thanks to the fixed throttle setting, the engine always operates at the optimum working speed after start-up.

#### Start procedure when the engine is cold:

- Press the primer (14) three times.
- Press and hold the motorstop lever (L).

- Slowly pull the recoil starter rope (B) to the point of resistance. Then pull vigorously and quickly to arm's length. Slowly return the recoil starter rope (B) so that it is gradually rolled up again. Repeat until the engine starts.

#### Start procedure when engine is warm:

### NOTE



When the engine is at operating temperature, the primer must no longer be pressed.

However, it should be noted that the engine can cool down very rapidly in very cold weather.

- The start procedure is the same as when the engine is cold. However, it is not necessary to press the primer (14).

### 10.02 Stopping the engine



9

To switch off the engine, release the motorstop lever (L). The engine and blade come to a standstill following a brief run-down time.

### 10.03 Emptying the grass catcher bag

### WARNING

#### Risk of injury!

The engine must be switched off before removing the grass catcher bag.

- Detach and empty the grass catcher bag (K). (⇒ 07.05)
- Reattach the grass catcher bag (K). (⇒ 07.05)

## 11. Maintenance

### WARNING

#### Risk of injury!

Carefully read section 04, particularly subsection 04.05, before performing any maintenance or cleaning operations on the lawn mower, and strictly observe all the safety instructions.

### 11.01 Cleaning the machine



10

#### Maintenance interval:

After each use.

### WARNING

#### Risk of injury!

Detach the spark plug socket from the engine and empty the fuel tank (drive until empty). The dimensions of the wooden support must be strictly observed in order to prevent the lawn mower from tipping over.

- Select the lowest cutting level. (07.06)
- Fold down the upper handlebar. (07.02)
- Tilt up and lift the lawn mower as shown. Position the wooden support (22) (approx. 10x10x30 cm) underneath so that the lawn mower is prevented from tipping over.

### 11.02 Combustion engine

#### Maintenance interval:

See engine instruction manual.

Observe the operating and maintenance instructions contained in the engine instruction manual provided.

To achieve a long service life, it is always particularly important to maintain a sufficient level of oil and to change the oil and air filter regularly.

The recommended oil change intervals as well as information on engine oil and oil capacities can also be found in the engine instruction manual.

The cooling ribs must always be kept clean to ensure that the engine is adequately cooled.

### 11.03 Wheels

The ball bearings of the wheels are maintenance-free.

### 11.04 Wear limit for mowing blades



11

### WARNING

#### Risk of injury!

Carefully read and observe the “For your safety” section (⇒ 04.), particularly the “Maintenance and storage” section (⇒ 04.05).

#### Maintenance interval:

Before each use.

The mowing blade (15) must be cleaned before checking.

- Tilt the lawn mower upwards into the cleaning position. (⇒ 11.01)

#### Mowing blade thickness:

The blade thickness must be at least **2 mm** (M) at any point. The most important points are marked in the illustration. (Check using slide calliper).

#### Wear limit of the cutting edges:

The cutting edges may not be ground back by more than **5 mm** (N) during sharpening. When checking, place a ruler (16) against the front blade edge (17) and inspect for wear.

### 11.05 Mowing blade maintenance



12

### WARNING

#### Risk of injury!

Carefully read and observe the “For your safety” section (⇒ 04.), particularly the “Maintenance and storage” section (⇒ 04.05).

It is recommendable to have the mowing blade re-sharpened by a specialist dealer.

#### Maintenance interval:

Every 25 operating hours

#### Remove mowing blade:

Use a wooden block (20) (approx. 60 x 60 mm) to counterhold the mowing blade (15) during removal.

- Remove blade fastening screw (18).

#### Sharpen the mowing blade:

The following points must be observed when re-sharpening the mowing blade (15):

- Cool the mowing blade when sharpening, e.g. with water. The blade must not be allowed to display blue colouring, as this would reduce its cutting quality.
- Sharpen blades evenly to prevent vibrations due to imbalance.

DE

EN

FR

NL

IT

ES

PT

NO

SV

FI

DA

PL

SL

SK

TR

- Check blade for damage before installing. The blade must be replaced if notches or cracks are identified, if the cutting edges have been sharpened back by more than 5 mm, or if the blade is thinner than 2 mm at any point (wear limits (⇒ 11.04)).

#### Install the mowing blade:

Install the mowing blade (15) with the curved edges pointing upwards.

Use a wooden block (20) (approx. 60 x 60 mm) to counterhold the mowing blade (15) during installation.

- Fit the mowing blade (15) onto the blade mount (21) and tighten the blade fastening screw (18) with retaining washer (19) to a torque of **60 - 65 Nm**.

#### CAUTION



##### Risk of injury!

The prescribed tightening torque for the blade fastening screws of **60 - 65 Nm** must be strictly observed.

Replace the retaining washer (19) each time the blade is installed.

Additionally secure the blade fastening screw (18) with **Loctite 243**.

#### CAUTION



##### Risk of injury!

A worn blade may break off and cause serious injuries. The instructions for blade maintenance must therefore always be observed.

Blades are subjected to differing degrees of wear depending on the location and duration of use. If you use the mower on sandy ground or use it frequently under dry conditions, the blade will be subjected to greater loads and will wear more quickly than the average.

Always replace the blade fastening screw (18) and retaining washer (19) when replacing the mowing blade.

#### 11.06 Storage and winter break

#### NOTE



Carefully read and observe subsection "Maintenance and storage" (⇒ 04.05) before storing the machine.

Note the following points when storing the lawn mower for long periods (winter break):

- Thoroughly lubricate/grease all moving parts.
- Empty the fuel tank and carburettor (e.g. by running empty).
- Unscrew the spark plug and pour approx. 3 cm<sup>3</sup> of engine oil into the engine via the spark plug hole. Turn the engine several times with the spark plug removed.

#### WARNING



##### Fire hazard!

Keep the spark plug socket away from the spark plug hole due to danger of ignition.

- Re-install the spark plug.
- Perform oil change (⇒ engine instruction manual)
- Cover the engine well and store the machine in a dry, dust-free room in the normal position.

## 12. Transport



#### WARNING

##### Risk of injury!

Carefully read and observe the "For your safety" section (⇒ 04.), particularly the "Transport" section (⇒ 04.02).

The lawn mower must always be carried by two persons wearing suitable safety clothing (safety shoes, gloves).

Detach the spark plug socket.

#### Lifting or carrying the lawn mower

- Only lift or carry the lawn mower at the lifting point (20), and the upper handlebar (A) or, when the upper handlebar is folded, by the lower handlebar sections (D).

#### Transporting the lawn mower:

When transporting the lawn mower on a load floor (trailer, car etc.) always use suitable fastening material to prevent it from slipping. Attach rope or straps at the following points on the machine:

- Front wheel, rear wheel
- Lower handlebar sections
- Housing strut under discharge flap

## 13. Minimising wear and preventing damage

### Important information on maintenance and care of the product group

#### Petrol lawn mowers

Please always observe the following important information for the prevention of damage or excessive wear to your VIKING machine:

#### 1. Wearing parts

Some parts of the VIKING machine are subject to normal wear even when used properly and must be replaced in due time depending on type and duration of use.

These include:

- Blade
- Grass catcher bag

#### 2. Observance of the information in this instruction manual

The VIKING machine must be used, maintained and stored with the care described in this instruction manual.

Any damage caused by non-observance of the safety, operating and maintenance instructions is the sole responsibility of the user.

This applies in particular to:

- Improper use of the product
- Use of fuel and lubricants not approved by VIKING (lubricants, petrol and engine oil, see engine manufacturer's specifications),
- Product modifications not approved by VIKING
- Use of attaching parts, attachments or cutting tools not approved by VIKING,
- Use of the product for sporting or competitive events
- Resultant damage due to continued use of the product with defective components.

#### 3. Maintenance operations

All operations listed in the "Maintenance" section must be performed regularly. If these maintenance operations cannot be performed by the user himself, an authorised specialist dealer must be commissioned. VIKING recommends that you have maintenance operations and repairs performed exclusively by a VIKING specialist dealer.

VIKING specialist dealers regularly attend training courses and are provided with technical information.

If these operations are neglected, faults may arise which are the responsibility of the user.

These include:

- corrosive and other resultant damage caused by incorrect storage
- damage and resultant damage due to the use of spare parts which are not original VIKING parts,
- damage due to maintenance and repair operations not performed in the workshops of authorised specialist dealers

## 14. Environmental protection



Clippings should be composted and not disposed of in household waste.

The machine, its packaging and accessories are all produced from recyclable materials and must be disposed of accordingly.

By disposing of materials separately, and in an environmentally-friendly manner, valuable resources can be re-used. For this reason, the machine should be disposed of for recycling at the end of its useful life.

Render the engine unusable prior to disposal. Remove the ignition lead, empty the fuel tank and drain the engine oil in particular.

#### Risk of injury caused by the cutting unit.

Always store an old lawn mower in a safe place prior to scrapping. Ensure that the machine and the blade are kept out of the reach of children.

## 15. Standard spare parts

### Mowing blade

6350 702 0100

The fastening elements of the mowing blade (e.g. blade fastening screw, lock washer) must be replaced when replacing the blade or when installing the blade. Spare parts are available from a VIKING specialist dealer.

DE

EN

FR

NL

IT

ES

PT

NO

SV

FI

DA

PL

SL

SK

TR

## 16. Technical specifications

	Unit	MB 248.0
Serial number		6350
Engine, design		4-stroke combustion engine B&S 450 Series
Type		
Displacement	ccm	148
Nominal output at nominal speed	kW-U/rpm	1,8-2800
Fuel tank	l	0.9
Starter		Rope start
Cutting tools		Cutter bar
Cutting width	cm	46
Engine output speed	rpm	2800
Cutter bar drive		drive
In accordance with Directive 2000/14/EC: Guaranteed sound power level $L_{WA,d}$	dB(A)	96
In accordance with Directive 2006/42/EC: Sound pressure level at workplace $L_{pA}$	dB(A)	85
Uncertainty $K_{pA}$	dB(A)	2
Specified vibration characteristic in accordance with EN 12096: measured value $a_{hw}$	m/sec <sup>2</sup>	4,85
Uncertainty K	m/sec <sup>2</sup>	2,43
Measurement in accordance with EN 20643		
Wheel diameter (front)	mm	177
Wheel diameter (rear)	mm	200
Cutting heights	mm	23 - 73
L/ W/ H	cm	151x53x100
Weight	kg	28

## 17. CE - Manufacturer's declaration of conformity

We,

VIKING GmbH  
Hans Peter Stihl-Straße 5  
A-6336 Langkampfen / Kufstein

declare, that the machine,

manually-operated lawn mower with combustion engine,

manufacturer's brand: VIKING  
type: MB 248.0  
Production identification: 6350

conforms to the following EU guidelines:  
97/68/EC, 2000/14/EC, 2004/108/EC, 2006/42/EC

The product has been developed in conformance with the following standards:  
EN 836, EN 60335-1

Applicable conformity assessment procedure:  
Appendix VIII (2000/14/EC)

Name and address of relevant, named location:  
TÜV Rheinland Product Safety GmbH  
Am Grauen Stein  
D-51105 Köln

Compilation and storage of technical documentation:  
VIKING GmbH  
Johann Weiglhofer  
Research and Product Development Manager

Measured sound power level:  
94,0 dB(A)

Guaranteed sound power level:  
96 dB(A)

The year of manufacture and serial number appear on the identification plate of the machine.

Langkampfen,  
03.01.2011  
VIKING GmbH

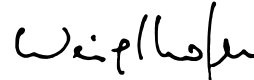

Weiglhofer  
Research and Product Development Manager

## 18. Troubleshooting

Fault	Possible cause	Remedy	Page	Section
- Engine will not start	- Motorstop lever is not pulled	- Press motorstop lever to handlebar	10	10.01
	- No fuel in tank; fuel line blocked - Inferior, dirty or old fuel in tank	- Top up fuel; clean fuel line - Always use fresh, good quality fuel, normal unleaded petrol; clean carburettor	9 9	07.07 07.07
	- Dirty air filter	- Clean air filter		
	- Spark plug socket detached from spark plug; ignition lead not properly fastened to socket	- Connect spark plug socket; check connection between ignition lead and socket.		
	- Spark plug dirty or damaged; incorrect electrode gap	- Clean or replace spark plug; adjust electrode gap.	, ✘	
	- Primer not actuated	- Press the primer three times.	10	10.01
- Starting problems or deteriorating engine performance	- Lawn mower housing is blocked	- Clean housing (detach spark plug socket)	11	11.01
	- Mowing at an excessively low cutting height or fast pushing speed - Water in fuel tank and carburettor; carburettor blocked - Contaminated fuel tank - Dirty air filter - Dirty spark plug	- Set higher cutting height / reduce pushing speed  - Empty fuel tank, clean fuel line and carburettor - Clean fuel tank - Clean air filter - Clean spark plug	9  ✘ ✘  , ✘	07.06
- Excessive vibration during operation	- Cutting unit defective	- Check blade, blade shaft, nuts and washers of cutting unit, repair if necessary	✘	
	- Loose engine mounting	- Tighten engine fastening bolts	✘	
- Engine overheating	- Oil level in engine too low	- Top up engine oil	9	07.07

see engine instruction manual

✘ If necessary, contact a specialist dealer; VIKING recommends VIKING specialist dealers.

DE

EN

FR

NL

IT

ES

PT

NO

SV

FI

DA

PL

SL

SK

TR



## 19. Service schedule

Provide your VIKING specialist dealer with this instruction manual when you have maintenance operations performed on your VIKING product.

Your VIKING specialist dealer will confirm the correct performance of the required service operations in the "Service schedule" section.

Model: **MB 248.0**

Serial number:

VIKING dealer stamp

**Handed over**

Date:

**Next service**

Date:

Date:

VIKING dealer stamp

**Next service**

Date:

Date:

VIKING dealer stamp

**Next service**

Date:

Date:

VIKING dealer stamp

**Next service**

Date:

Date:

VIKING dealer stamp

**Next service**

Date:

Date:

VIKING dealer stamp

**Next service**

Date:

Date:

VIKING dealer stamp

**Next service**

Date:





[www.viking-garden.com](http://www.viking-garden.com)

**VIKING®**



0478 111 9916 C