

Maxi 140

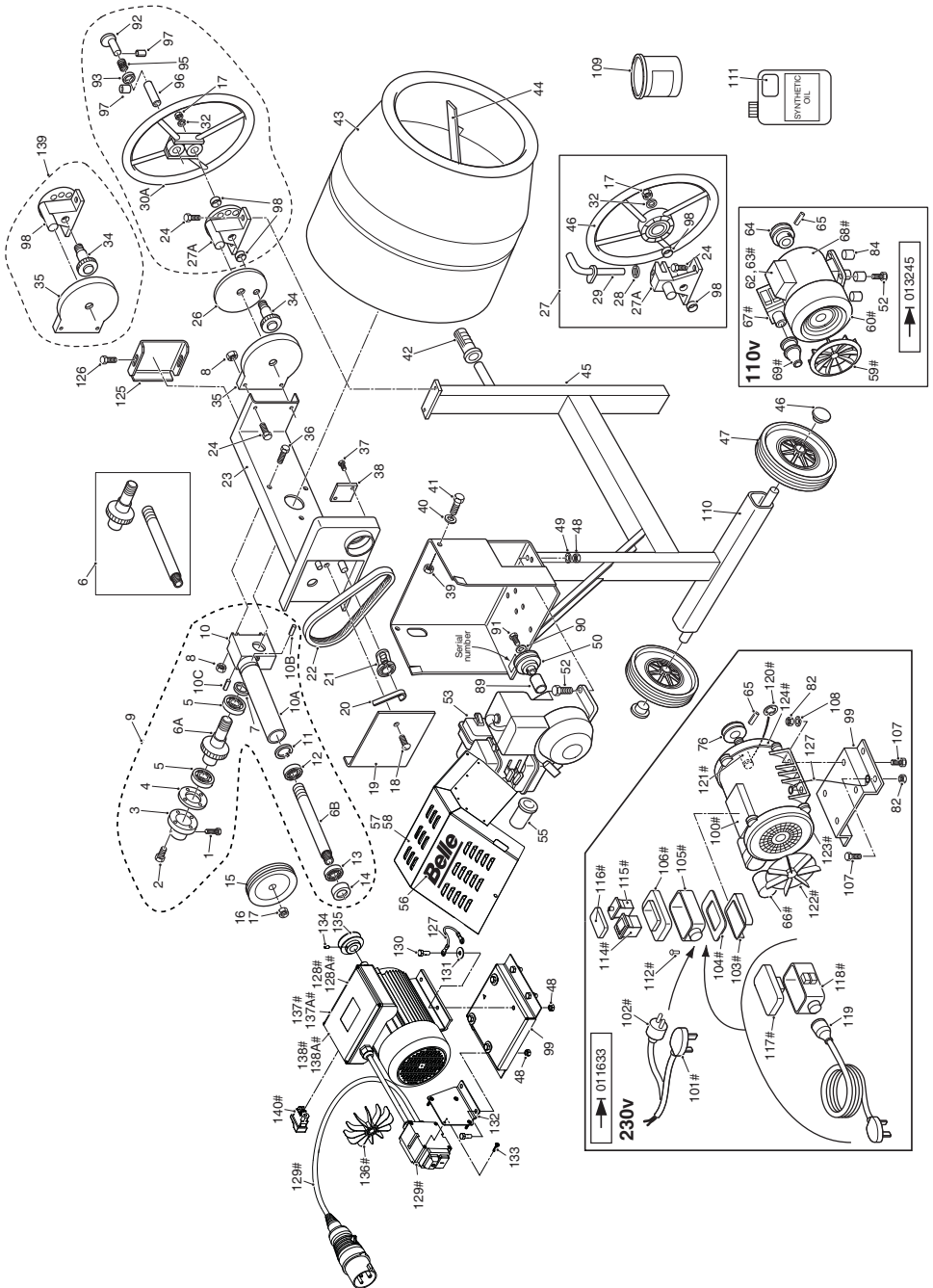

- ⚠ **CAUTION:** PARTS WITH A # SHOULD ONLY BE FITTED BY A QUALIFIED ELECTRICIAN.
- ⚠ **PRECAUCION:** LAS PARTES MARCADAS CON # SOLO DEBEN INSTALARSE POR UN ELECTRICISTA CAPACITADO.
- ⚠ **VARNING:** KOMPONENTER MED A # BÖR ENDAST MONTERAS AV EN UTBILDAD ELEKTRIKER.

Maxi 140

Item Number	Part Number	Description	Qty	Item Number	Part Number	Description	Qty
1	XS01	Filler Bung	1	67	CMS63	Switch Box Nvr (110v)	1
2	9/8012	Bolt (M8 x 20)	4	68	902/14300	Motor Kit (110v-50Hz)	1
3	902/13702	Cover	1	69	900/15200	Coupler (110v)	1
4	XS27	Gasket	1	76	902/11300	Pulley - M30	1
5	CMS10	Bearing (6006)	2	82	8/8008	Nut M8 Nylco	4
6	XS40	Kit Worm & Mainshaft	1	84	XS17	Spacer	4
6A	XS03	Mainshaft	1	89	XS16/2	Spacer (Honda)	1
6B	XS26	Wormshaft	1	90	4/8004	Washer (M8)	1
7	CMS11	Oilseal	1	91	9/0002	Bolt (5/16 x 5/8 UNF)	1
8	8/10003	Nut	2	92	902/10500	Plunger	1
9	902/14100	Gearbox Assembly Kit	1	93	902/10600	Retainer Spring	1
10	902/14100	Gearbox Case	1	95	2/0004	Spring	1
10A	XS23	Wormshaft Tube	1	96	50/000038	Bush	1
10B	XS04	Spiral Pin (-> 011916)	1	97	3/0020	Roll Pin (3 x 14)	1
10C	7/6031	Grubscrew M6 x 12 (-> 011917)	1	98	902/14200	Pinion Kit (Inc. 27a, 34, 35 & 98)	1
11	XS05	Circlip	1	99	902/11400	Motor Deck M30 (-> 011633)	1
12	XS31	Bearing (6005)	1	99	902/99902	Motor Deck (-> 011634)	1
13	PS013	Bearing (6004)	1	100	900/20400	Kit Motor M30 NVR (240v)	1
14	CMS40	Oilseal	1	100	900/17500	Motor M30 (220v)	1
15	CMS39	Pulley	1	100	900/17800	Motor NVR (220v CEE7)	1
16	9/12008	Bolt (M12 x 20)	1	101	900/18800	3 Pin Plug & Cable (240v)	1
17	8/12002	Nut (M12)	1	102	900/18900	2 Pin Plug & Cable (220v)	1
18	7/6010	Screw (M6 x 35)	1	103	900/19200	Adaptor Plate	1
19	XS22	Belt Guard	1	104	900/19600	Gasket	1
20	XS19	Jockey Spring	1	105	900/18500	Switch Boxbase	1
21	902/15600	Jockey	1	106	900/18400	Lid Assembly (220v & 240v)	1
22	XS21	Belt (A30)	1	107	7/8008	Set Screw (M8 x 16)	4
22A	902/13300	Belt (60Hz)	1	108	4/8008	Washer (5/16" x 1")	4
23	XS08	Yoke	1	109	1/0519	Paint - 1 Litre Tin (Orange)	1
24	7/10004	Screw (M10 x 20)	2	109A	1/0507	Paint - Spray (Orange)	1
25	8			110	902/13400	Axle	1
26	XS11	Tip Gear Cover	1	111	1/1100	Synthetic Oil - 5 Litre Drum	1
27	30B			112	900/19100	Rivet	4
27A	902/14200	Pinion Kit (Inc. 27a, 34, 35 & 98)	1	113	900/19000	Switch Screw	1
28	PS071	Washer (8mm)	1	114	CMS27	Rocker Switch (240v White)	1
29	XS36	Locking Pin	1	115	900/18700	Overload (4 Amp)	1
30	30B			116	900/18600	Switch Cover & Ring	1
30A	902/11100	Handwheel	1	117	900/19300	Lid Assembly NVR (220v & 240v)	1
30B	902/13100	Kit Handwheel	1	118	900/19400	Switch Box Base (240v CEE7)	1
31	17			119	900/18100	Extension Cable (240v)	1
32	4/1205	Washer (M12)	1	120	600/03150	Circlip	1
33	24			121	900/15000	Motor Shaft Sleeve	1
34	XS10	Tip Gear	1	122	900/16500	Fan (M30 Motor)	1
35	XS09	Gear Ring	1	123	900/16800	Fan Cover	1
36	9/10009	Bolt (M10 X 45) (-> 011916)	2	124	900/16700	Motor Cover (Pulley End)	1
36A	7/10009	Screw (M10 X 40) (-> 011917)	2	125	902/13500	Yoke Guard	1
37	7/6011	Set Screw (M6 x 10)	2	126	7/5006	Screw (M5 x 16)	1
38	XS41	Cover Plate	2	127	71/0250	Cable Earth	1
39	8/6002	Nut (M6)	2	128	20/0100	Motor (110v)	1
40	4/6001	Washer (M6)	2	128A	902/14800	Motor Kit (230v) (-> 000614)	1
41	7/6001	Set Screw (M6 x 12)	2	128A	20/0108	Motor (230v) (-> 000615)	1
42	XS35	Handle Grip	1	129	902/14400	Remote Switch & Cable (110v)	1
43	CMS12SP	Drum	1	130	7/8011	Set Screw (M8 x 20)	4
44	CMS13	Paddle Kit	1	131	4/8008	Washer (M8) (110v)	4
45	902/10100	Mainframe	1	131A	4/8006	Washer (M8) (230v)	4
46	CMS16	Axle Cap	2	132	902/99904	Switch Support Pressing (110v)	1
47	60/0286	Wheel	2	133	7/5019	Screw (M5 x 19)	4
48	8/8001	Nut (M8)	2	134	7/6013	Grubscrew (M6 x 12)	1
49	4/8002	Washer (M8)	2	135	XS16/1	Pulley	1
50	MS18	Pulley (3/4" Bore)	1	136	902/99906	Fan	1
50A	XS16	Pulley (Honda)	1	137	902/14600	Capacitor Box w/o Capacitors (110v)	1
50B	MS17	Pulley (B & S Vanguard)	1	137A	902/14500	Capacitor Box w/o Capacitors (230v)	1
52	9/8003	Bolt (M8 x 35)	2	138	902/14700	Capacitor x 2 (110v)	1
52A	7/8008	Screw (M8 x 16) (B & S Vanguard)	2	138A	70/0135	Capacitor x 1 (230v)	1
53A	20/0038	Engine (Honda)	1	139	902/14200	Pinion Kit (Inc. 27a, 34, 35 & 98)	1
53B	20/0080	Engine (B & S Vanguard)	1	140	70/0194	Switch (240v)	1
55	XS29	Exhaust	1	902/10900		Decal Operating	1
55A	902/14000	Exhaust (B & S Vanguard)	1	800/99912		Decal Safety	1
56	800/03100	Decal Maxi 140	1	800/99809		Decal Danger Zone (UK)	1
57	XS18	Lid	1	800/21314		Decal Danger Zone (Euro 3)	1
59	CMS24	Fan (110v & 240v)	1				
60	CMS25	Fan Cowl (110v & 240v)	1				
60A	CMS08	Fan Cowl Clip	1				
62	CMS17	Capacitor Cover	1				
63	CMS29	Capacitor (110v Silver)	1				
64	MS17	Pulley (5/8" Bore)	1				
64A	CMS64	Pulley (60Hz)	1				
65	7/6008	Grub Screw (M6 x 8)	1				
66	CMS21	Capacitor - 240v White	2				



BELLE
LIGHT
CONSTRUCTION
EQUIPMENT

ALTRAD BELLE
Sheen, Nr. Buxton, Derbyshire, SK17 0EU, GB
Tel. +44 (0)1298 84606 - Fax +44 (0)1298 84722 - Email: sales@altrad-belle.com
www.Altrad-Belle.com